



**HYATT**  
REGENCY™  
Kuantan Resort

# HYATT REGENCY KUANTAN RESORT





## DESTINATION

Located on the stunning beachfront of Teluk Cempedak along the east coast of peninsular Malaysia, the refurbished Hyatt Regency Kuantan Resort with 300 rooms provide a tranquil break from the city against breathtaking views of the South China Sea. Complete with family-friendly facilities, two outdoor swimming pools and a variety of restaurants and bars, the resort is the ideal spot to relax and recharge over meaningful connections that last a lifetime.



#### LOCATION

Hyatt Regency Kuantan Resort set on the beachfront of Teluk Cempedak with a 800 metre long beach offering panoramic views of the South China Sea, the resort is 30 minutes from Sultan Haji Ahmad Shah Airport (KUA) in Kuantan, or 2.5 hours from Kuala Lumpur via East Coast Expressway

#### PARKING

24-hour on-site parking is available for 200 vehicles in two outdoor car parks. In-house hotel guests can enjoy complimentary parking.

#### TRANSPORTATION

- Airport - 25.7 km; 30 min / Taxi
- Terminal Sentral Kuantan (Bus Station) - 16 km; 21 min / Taxi

#### AMENITIES

- 24-hour Concierge
- Business Services
- Restaurant On-Site
- Laundry / Dry Cleaning
- Room Service
- Fitness Centre
- Pool
- Currency Exchange
- Car Parking Facilities
- Tour Desk and Car Rental
- Regency Club™

## ACCOMMODATIONS

Hyatt Regency Kuantan Resort welcomes you to our 300 refurbished guestrooms, including 12 luxurious suites and 19 family-oriented rooms, and featuring a modern aesthetic design, accentuated by traditional Malaysian craft elements.

## SUITES

### REGENCY SUITE KING

Enjoy the extra space in this elegant 91 sq m suite, with one king bedroom, living and dining spaces, balcony and access to the Regency Club Lounge. This standard suite comes with complimentary buffet breakfast served daily at Kampung restaurant. Canapés and cocktails are served daily at the Club Lounge from 6:00 PM to 8:00 PM. See World of Hyatt programme terms for upgrade eligibility.

### REGENCY EXECUTIVE SUITE

This luxurious 84-85 sq m suite offers one king bedroom, stunning sea views from the large private balcony and separate living spaces and Regency Club Lounge access and privileges. This premium suite comes with complimentary buffet breakfast served daily at Kampung restaurant. Canapés and cocktails are served daily at the Club Lounge from 6:00 PM to 8:00 PM. See World of Hyatt programme terms for upgrade eligibility.

### ROYAL SUITE

This stately 124 sq m suite boasts one king bedroom, stunning sea views from the large private balcony, separate dining and entertainment spaces as well as a kitchenette, plus Regency Club Lounge access and privileges. This premium suite comes with complimentary buffet breakfast served daily at Kampung restaurant. Canapés and cocktails are served daily at the Club Lounge from 6:00 PM to 8:00 PM. See World of Hyatt programme terms for upgrade eligibility.





## ROOMS

### 1 KING BED

Recharge in this 34 sq m one king bed room with open plan bathroom, walk-in shower, private balcony and multipurpose desk.

### 2 TWIN BEDS

Recharge in this 34 sq m two twin beds room with open plan bathroom, walk in shower, private balcony and multipurpose desk.

### 1 KING BED DELUXE

Unwind in this spacious room, offering one king bed, walk-in closet in an open plan bathroom, standing shower and multipurpose desk amid 39-40 sq m of space.

### 2 TWIN BEDS DELUXE

Unwind in this spacious room, offering two twin beds, walk-in closet in an open plan bathroom, standing shower and multipurpose desk amid 39-40 sq m of space.

### 1 KING BED WITH SEA VIEW

With stunning sea views, this king bed guestroom with 34 sq m of space features a private balcony, open plan bathroom, standing shower and multipurpose desk.

### 2 TWIN BEDS WITH SEA VIEW

With stunning sea views, this two twin beds guestroom with 34 sq m of space features a private balcony, open plan bathroom, standing shower and multipurpose desk.

### 1 KING BED FAMILY

This spacious and stylish 68 sq m room with garden views, offers a master bedroom with one king bed, separate living spaces with one queen sofa bed and a daybed. Ideal for families with young children or for extended stays.

### 1 KING BED WITH SEA VIEW AND CLUB ACCESS

In addition to Regency Club access, this king bed room offers stunning sea views, an open plan bathroom with standing shower or long bathtub. Complimentary buffet breakfast is served daily at Kampung restaurant, while canapés and cocktails are served daily at the Club Lounge from 6:00 PM to 8:00 PM.

### 1 KING BED WITH CLUB ACCESS

The spacious 39-40 sq m Club King room offers access to the Regency Club Lounge, an open plan bathroom with standing shower or long bathtub. Complimentary buffet breakfast is served daily at Kampung restaurant, while canapés and cocktails are served daily at the Club Lounge from 6:00 PM to 8:00 PM.

### 2 TWIN BEDS WITH SEA VIEW AND CLUB ACCESS

In addition to Regency Club access, this two twin beds room offers stunning sea views, an open plan bathroom with standing shower or long bathtub. Complimentary buffet breakfast is served daily at Kampung restaurant, while canapés and cocktails are served daily at the Club Lounge from 6:00 PM to 8:00 PM.

### 2 TWIN BEDS WITH CLUB ACCESS

The spacious 39-40 sq m Club two twin beds room offers access to the Regency Club Lounge, an open plan bathroom with standing shower or long bathtub. Complimentary buffet breakfast is served daily at Kampung restaurant, while canapés and cocktails are served daily at the Club Lounge from 6:00 PM to 8:00 PM.



## DINING

Hyatt Regency Kuantan Resort invites you to enjoy authentic gastronomy with breathtaking views of the South China Sea. Savour the best of Malaysia's diverse flavours all-day at Kampung, authentic Italian cuisine at Italian Bistro, casual tapas at Coals on the Beach and unwind in the evening with cocktails at Sampan Bar or head to Chukka for live entertainment. In-room dining options are also available in the privacy and comfort of your room.

## KAMPUNG

The diversity of Malaysia's food culture converges at Kampung, the hotel's all-day dining restaurant located on the Ground Floor. Featuring live open show kitchens, serving a combination of Western, traditional Malay, Indian as well as local Chinese cuisines.

Daily: 6:30 AM to 10:30 PM

Breakfast Buffet:

Daily: 6:30 AM to 10:30 AM

Lunch and Dinner à la carte:

Daily: 11:30 AM to 10:30 PM

## ITALIAN BISTRO

Delight in classic Italian antipasti, gourmet pizzas and pastas with the option of indoor and alfresco dining areas. The indoor dining also features a private room that is ideal for intimate gatherings for up to 20 guests.

Monday - Saturday: 7:00 PM to 11:00 PM

Close on Sundays

## COALS ON THE BEACH

Located on the beachfront with the most spectacular view of the South China Sea, Coals on the Beach is ideal for leisurely evenings out with family or friends, casual business dinners or romantic dinners.

Wednesday - Monday: 3:00 PM to 11:00 PM

Close on Tuesday





### SAMPAN BAR

Relax at our beachfront Sampan Bar and wind down your evening with a selection of signature cocktails and house pours.

Daily: 12:00 PM to 10:00 PM

### THE DELI

Our one-stop gourmet delicatessen is perfect for your daily baked breads, cookies and savoury items. It's an ideal place to enjoy a quiet bite and some beverages or simply grab-and-go.

Daily: 9:00 AM to 9:00 PM

### CHUKKA

Groove the night away with first-class live entertainment and variety of popular hits spun by our resident DJ. At the heart of all the action at Chukka is a bar that showcases an extensive selection of single malt whiskeys, wine and spirits. Watch our bartenders create cocktails and classic drinks with new twists.

Tuesday - Thursday: 6:30 PM to 1:00 AM

Friday - Saturday: 6:30 PM to 2:00 AM

Close on Sunday - Monday







## MEETINGS & EVENTS

### MEETINGS & EVENTS

Convene with distinct difference at Hyatt Regency Kuantan Resort, Malaysia. Our multiple, refreshed event spaces and spectacular outdoor venues are perfect for your energising and memorable event experiences. We have over 900 sq m of versatile and refurbished meeting and event spaces to suit every occasion from conferences, receptions to social events.

### MEETINGS

Enjoy a seamless meeting experience as a planner or a guest with the resort's refurbished meeting venues, and be inspired by advanced audio visual and communication technologies, versatile staging facilities, and dedicated event-planning team.

Allow our Kuantan hotel team to assist in your event planning. From elegant indoor spaces to captivating outdoor settings, Hyatt Regency Kuantan Resort offers a wide range of event venues for any and every occasion.

### WEDDINGS

Exchange your vows and celebrate a lifetime of memories at the romantic and idyllic beachfront location of Hyatt Regency Kuantan Resort.

Add sparkle to your once-in-a-lifetime occasion and choose from beautiful spaces, with the flexibility for an intimate celebration, dinners, or pristine beach and garden spaces with ocean vistas.

CAPACITY CHART  
Lobby Level



Room Name	Room Dimensions L x W x H	Room Size Sq. Ft. / Sq. M.	Banquet	Reception	Theater	Classroom	Boardroom	U-Shape	Hollow Square
KEMPAS	43.6' x 44.2' x 10.5' 13.3m x 13.5m x 3.2m	1,927 179	160	—	128	72	—	60	72
KEMPAS I	21.9' x 44.2' x 10.5' 6.7m x 13.5m x 3.2m	968 90	60	—	64	36	28	30	36
KEMPAS II	21.6' x 44.2' x 10.5' 6.6m x 13.5m x 3.2m	957 89	60	—	64	36	28	30	36
PRE-FUNCTION HALL	43.6' x 19.7' x 10.5' 13.3m x 6m x 3.2m	860 79.9	—	60	—	—	—	—	—

FLOOR PLAN  
Lobby Level

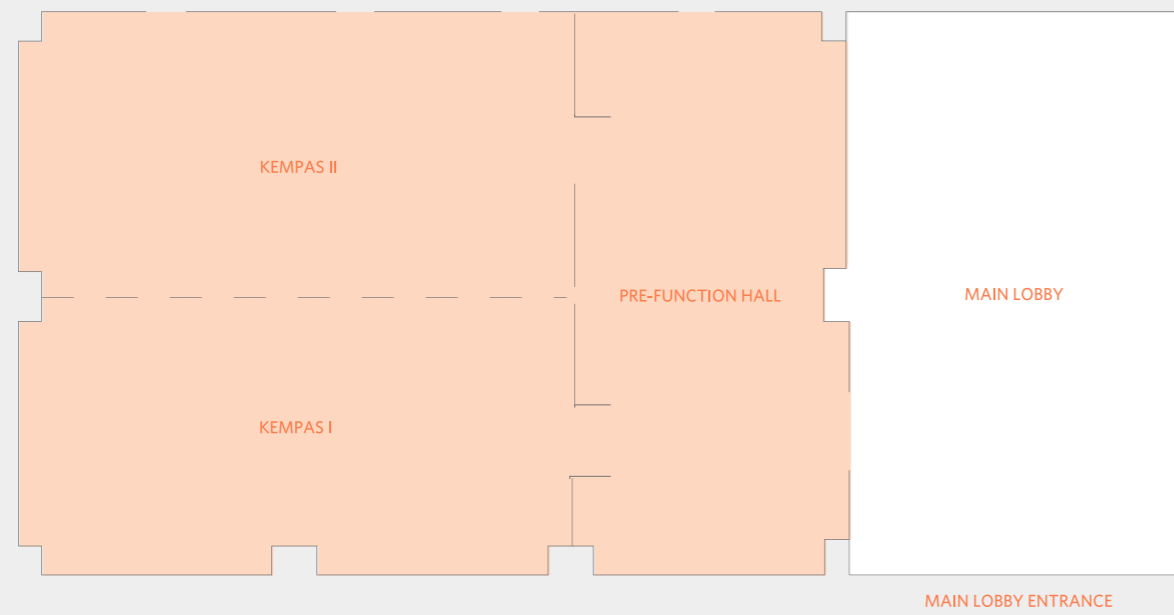

CAPACITY CHART  
Level One



Room Name	Room Dimensions L x W x H	Room Size Sq. Ft. / Sq. M.	Banquet	Reception	Theater	Classroom	Boardroom	U-Shape	Hollow Square
MERANTI BALLROOM	58.4' x 82' x 19' 17.8m x 25m x 5.8m	4788.9 444.9	400	600	600	250	—	80	100
MERANTI I	58.4' x 32.9' x 19' 17.8m x 10m x 5.8m	1921.4 178.5	150	240	240	100	—	50	60
MERANTI II	58.4' x 49' x 19' 17.8m x 14.9m x 5.8m	2,867.5 266.4	250	360	360	120	—	80	80
JATI	55.6' x 20.7' x 9.5' 17m x 6.3m x 2.9m	1,151 107	60	60	50	50	30	30	50

FLOOR PLAN  
Level One

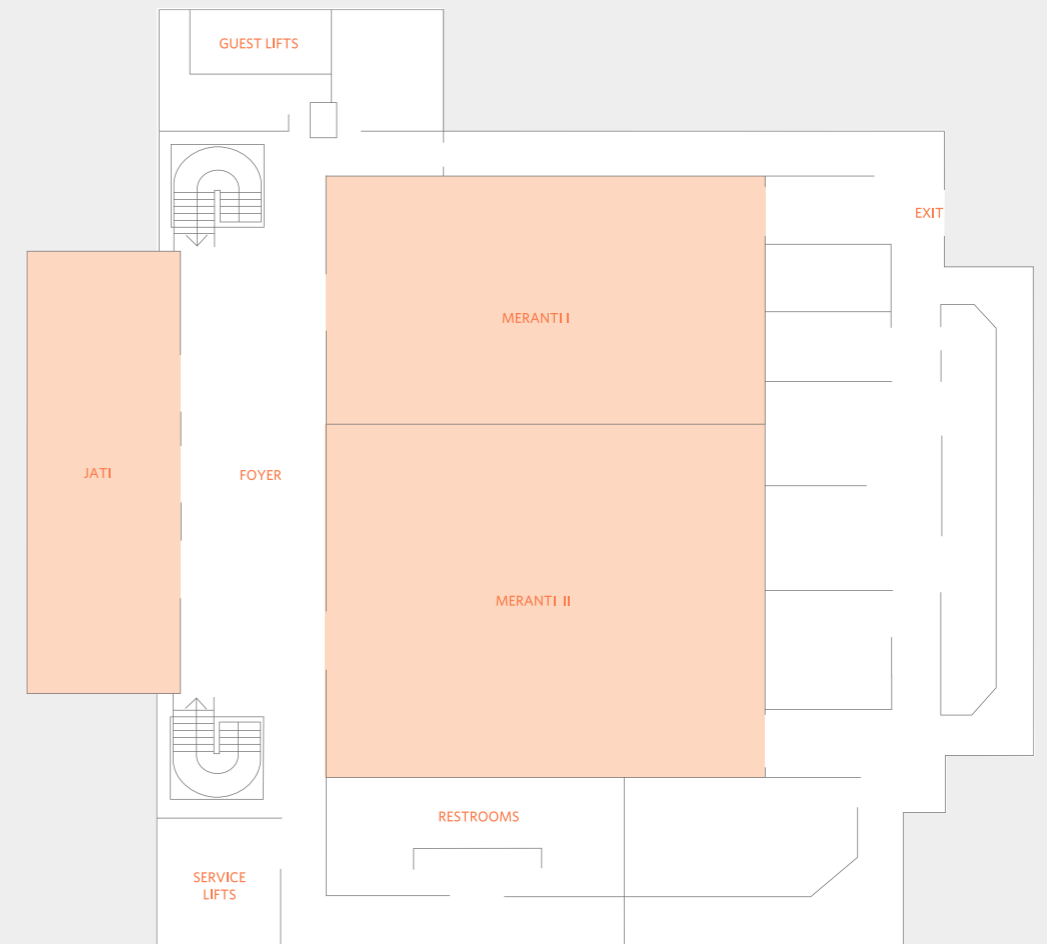

CAPACITY CHART  
Level Two



Room Name	Room Dimensions L x W x H	Room Size Sq. Ft. / Sq. M.	Banquet	Reception	Theater	Classroom	Boardroom	U-Shape	Hollow Square
CHENGAL	15.7' x 22.9' x 9.5' 4.8m x 7m x 2.9m	359 33	—	—	—	—	12	—	—
NYATOH	15.7' x 22.9' x 9.5' 4.8m x 7m x 2.9m	359 33	—	—	—	—	12	—	—
RAMIN	72.2' x 16.4' x 9.5' 22m x 5m x 2.9m	1,178 110	60	70	70	30	30	30	36
RAMIN I	23.8' x 16.4' x 9.5' 7.25m x 5m x 2.9m	390 36.3	20	25	25	12	12	9	12
RAMIN II	23.6' x 16.4' x 9.5' 7.2m x 5m x 2.9m	387 36	20	25	25	12	12	9	12
RAMIN III	24.6' x 16.4' x 9.5' 7.3m x 5m x 2.9m	394 36.5	20	25	25	12	12	9	12

FLOOR PLAN  
Level Two

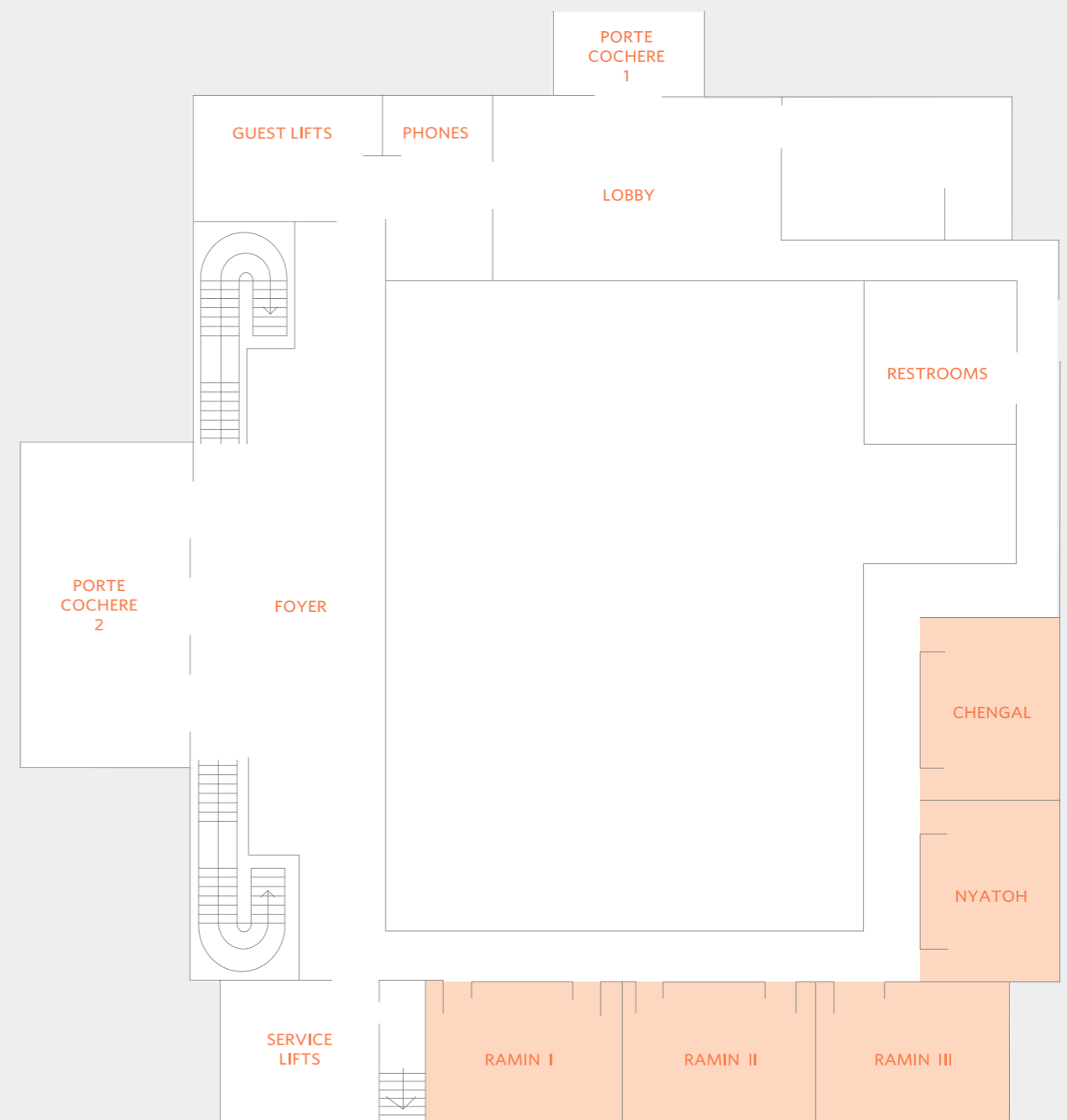

### VISITOR INFORMATION

- Climate: Tropical with temperatures ranging between 23 to 34°C
- Voltage: 220 to 440 volts AC
- Currency: Malaysia Ringgit (MYR)

### POINTS OF INTEREST

- Teluk Cempedak Beach
- Handicraft Centre
- Sungai Lembing
- Charas Cave
- Sungai Pandan Waterfall
- Royal Town - Pekan
- Natural Batik Village
- Cherating Beach
- Beserah Beach
- Rimbung Dahan Turtle Hatchery
- Taman Negara
- Gunung Tapis





**HYATT**  
**REGENCY™**

**KUANTAN RESORT**

HYATT REGENCY KUANTAN RESORT

Teluk Cempedak

25050 Kuantan, Pahang, Malaysia

T +60 9 518 1234

[hyattregencykuantanresort.com](http://hyattregencykuantanresort.com)

[kuantan.regency@hyatt.com](mailto:kuantan.regency@hyatt.com)